

# Cadro frame system

- Base
- Wall / floor attachment

## Wall mount, concealed



- Concealed wall mount for Cadro profiles
- The Cadro profiles must be routed out and predrilled
- Attach the mount to the wall, then hook on the furniture elements and fix in place
- Precision adjustment capability in height after fitting
- Max. load capacity 60 kg per set
- Please note: the mounting hardware provided is suitable for usual, firm brickwork. Its suitability must be verified on site

Set comprises:

- 2 wall mounts, galvanised steel
- 2 flat head screws, 4 x 38 mm
- 2 plastic wall plugs, 7 x 35 mm
- 4 threaded studs, M5 x 6 mm, in 2 surface finishes

Order no.	PU
9 298 847	1 set

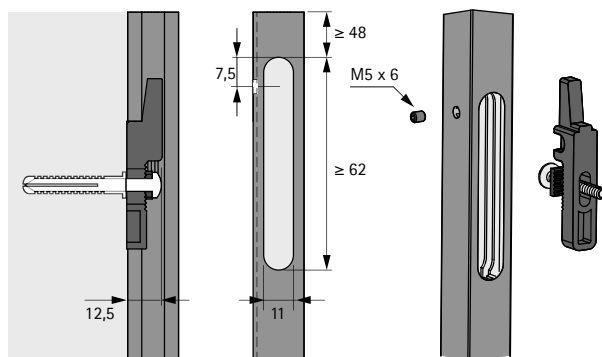
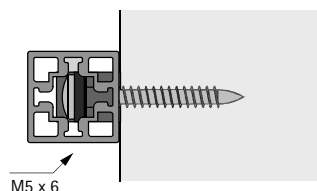
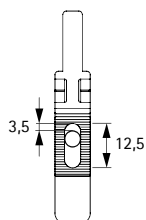

## Cover cap, Ø 10 mm, for direct attachment to wall



- To cover a Ø 10 mm hole when fixing the Cadro profile directly to the wall
- A Ø 4.5 mm through hole must be drilled at the centre of Cadro profile before drilling a further Ø 10 x 12 mm hole
- The profile must be fixed directly to the wall with a Ø 4 mm panhead screw; fixing screw not included
- The profile hole is concealed by the cover cap
- Plastic

Order no. / Colour		PU
black	grey	
9 298 854	9 298 855	20 ea.

